

Molded Lounge Ballasting Assembly Instructions

**Model Number
FC660-XXX**

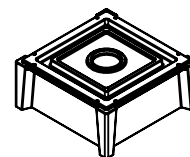

Assembly Notes: Norix is not responsible for any damage due to improper installation. If your shipment does not match the parts list, please contact Norix Customer Service at 800-234-4900. Norix reserves the right to modify design specifications at any time without an obligation to owners of previously sold products.

TOOLS NEEDED

Pin-in-Torx ® Driver T-40

1. Invert chair/table assembly. Remove (8) screws and washers and separate the Base from the rest of the unit.
2. Place the Base upright. Remove the Molded Cap and insert sand or pea gravel until the Base is filled with the desired amount of sand.
RECOMMENDED BALLAST WEIGHT: 50 LBS
MAXIMUM BALLAST WEIGHT: 100 LBS
Re-insert Molded Cap back into the Base.

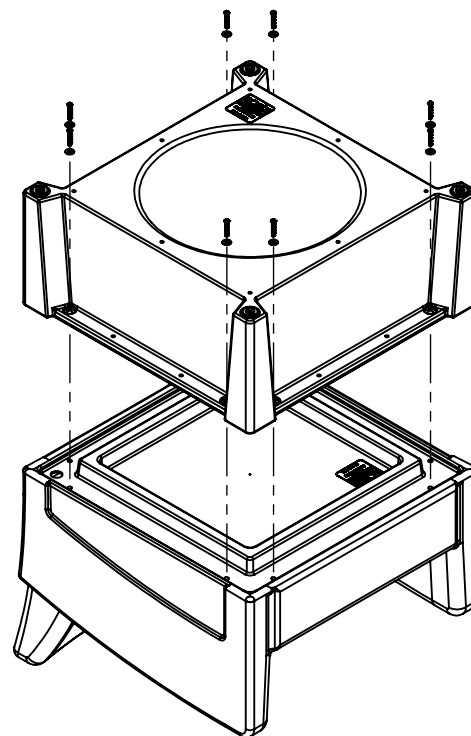

3. Reinstall the chair/table top in an upright position. Due to the weight of the ballasted Base, do not attempt to invert the Base for re-assembly. Tighten screws securely.

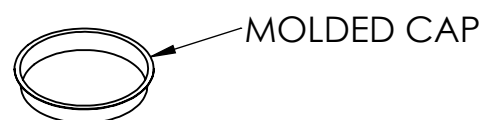

MOLDED CAP

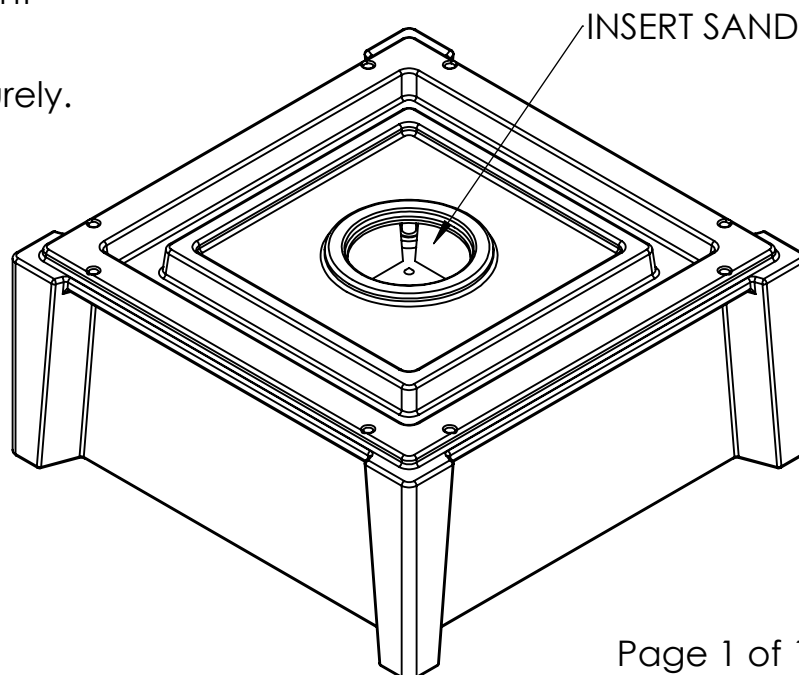

INSERT SAND